

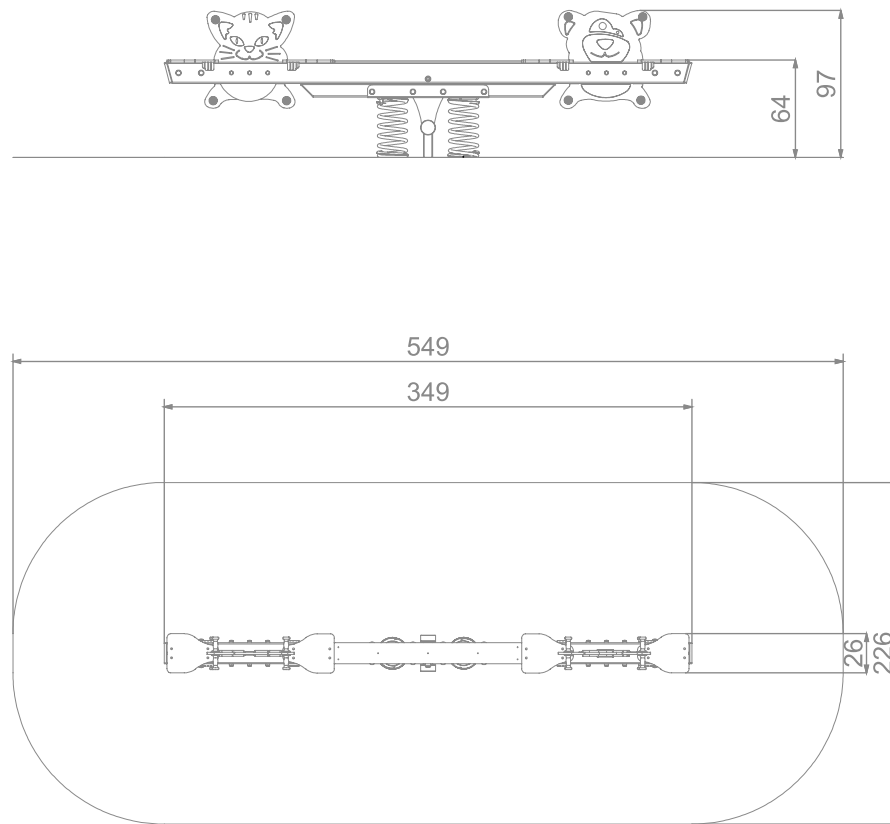

INFORMATION ABOUT THE PRODUCT

Dimensions	349 x 26 cm
Safety zone	549 x 226 cm
Safety zone area	11,54 m ²
Overall height	124 cm
Free fall height	98 cm
Amount of users	4
Product complies with EN 1176-1:2017-12	TAK
Availability of spare parts	TAK
Age range	3-12
<small>According to EN 1176-1:2017-12 norm, the product requires applying a safety surface according to the product's free fall height.</small>	





SCALE 1:50

MATERIALS:

SOFT CONIFER WOOD
90 X 90 MM, CORELESS,
GLUED IN LAYERS WITH
POLYURETHANE GLUES,
TOTALLY RESISTANT TO WATER.

PLATES OF THE WALLS
MADE OF COLOURFUL
TRIPLE LAYERED 15 MM
HDPE POLYETHYLENE, IN
THE HIGHEST QUALITY,
TOTALLY DAMP-PROOF.

ANTI-SLIP ANTHRACITE
10MM HPL PLATFORM
PLATE WITH A VERY HIGH
RESISTANCE TO WEATHER
CONDITIONS AND
ATTRITION.

SPRINGERS' SPRINGS MADE
OF SPRING STEEL

SOFT CONIFER WOOD
140 X 140 MM, CORELESS,
GLUED IN LAYERS WITH
POLYURETHANE GLUES,
TOTALLY RESISTANT TO WATER.

